

Handy Throttle



Product Instructions | Part No: 98020

Before you begin, read these instructions and check to be sure all parts and tools are accounted for. Please retain these installation instructions for future reference and parts ordering information.

Note: If any hardware is missing, do not return to the store. Call us to help, Toll Free 1-877-956-5746.

Kit contents:

Item	Qty	Part Description
1	1	Inner Bushing (Short Split Bushing)
2	1	Thumb Sleeve
3	1	Outer Bushing (Long Split Bushing)
4	1	Textured Grip (not shown)

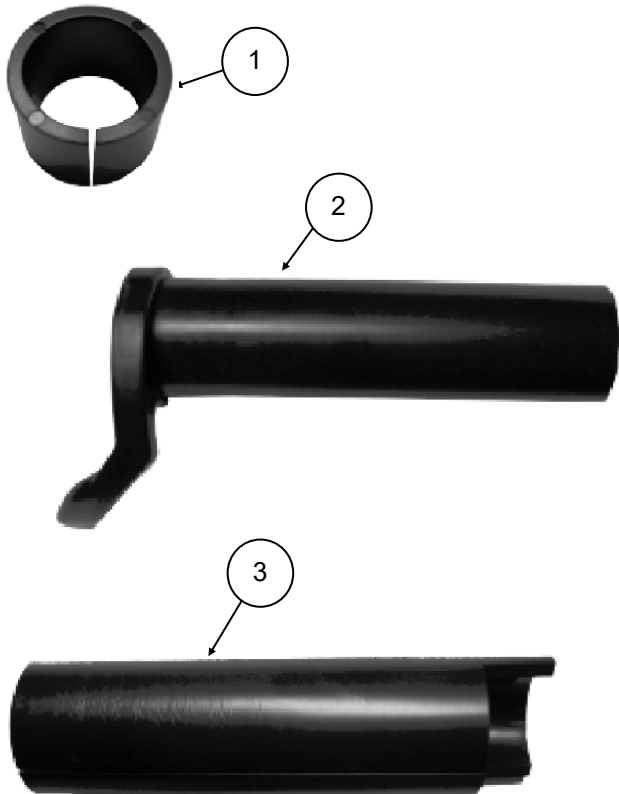

This throttle grip is designed to quickly and easily universal mount to any standard 7/8" diameter ATV handlebar.

WARNING:

Careless or improper use of this product can cause serious or even fatal injury.

- Prior to every ride, test the handy throttle from idle to full throttle to ensure free rotation and return to idle upon release of the throttle. Do not operate the vehicle if handy throttle does not rotate freely or return to idle upon release of the throttle.
- Restrict the use of this product to adult users who understand and can follow safety rules, precautions and operating instructions.
- Do not handle or operate this product when you are fatigued, ill or upset or if you have taken alcohol, drugs, or medication. You must be in good physical condition and mentally alert.
- Do not operate this product if it is damaged, improperly adjusted, or not completely and securely assembled.
- Never modify this product in any way.
- This product should not be used for any other purpose other than for which it is designed or intended. This product must not be altered, repaired or serviced by anyone other than the company or an authorized service center. The product must not have been subject to accident in transit or, while in the customer's possession, misused, abused or operated contrary to the instructions included. This includes failure caused by neglect, commercial use and acts of God.
- Full liability and responsibility for complying with all federal, state and local safety standards is assumed by any person or persons who modify this product in any way.
- Follow all ATV manufacturers warning and guidelines.
- You may wish to revert to factory thumb throttle when traversing steep, rocky or mountainous terrain.

Kolpin Outdoors, Inc. | 9955 59th Ave N | Plymouth, MN 55442

(877) 956-5746 or (763) 478-5800 | www.kolpin.com | customerservice@kolpin.com

Instructions:

1. Remove existing rubber grip from throttle side of handle bars. If glue or rubber residue is left on the handle bar, scrape it off.
2. If there is rubber sleeve on the existing thumb throttle it should be removed.
3. Loosen clamp bolts or screws on the thumb throttle housing so it slides in or out when gentle pressure is applied. This allows you to obtain clearance for free rotation of the handy throttle.
4. Slide Item 1 - Inner bushing over the metal handle bar until it rests against the throttle housing, it may be necessary to use a screwdriver and pry the inner bushing gap open to get it started.
5. Slide Item 2 - Thumb Sleeve over the handle bar and the inner bushing. This should slide on without any resistance.
6. Position Item 2 with the Plastic thumb against your throttle lever and hold it in that position.
7. To install Item 3 the Outer Bushing. Spray a light coat of glue on the inside of Item 3, (we recommend "Duro All-Purpose" spray adhesive). Line up the alignment marks on Items 2 & 3. You may need to pry the gap open on Item 3 to get it started.
8. After bushing is started on the handle bar, tap into position, flush with end of metal handle bar with a block of wood and a hammer.
9. When properly installed Item 3 should be flush with the end of the handle bar. Item 2 should stick out slightly from the end on the handle bar. Check to see if the Handy Throttle rotates back and forth with ease.
10. If the throttle binds, gently tap Item 2 inward. This will properly position the existing throttle housing, which will give the appropriate amount of clearance within the Handy Throttle. The throttle should operate with ease. If the Handy Throttle seems too loose, tap the throttle housing outward to take up the slack. Again check to see if the Handy Throttle rotates freely.
11. After Handy Throttle is properly adjusted tighten the thumb throttle housing.
12. To install the rubber grip, spray inside of the grip with glass cleaner to lubricate. Slip textured grip over Item 2. The grip should go on with some resistance. Once grip is in place the cleaner will evaporate and the grip will remain in place.

Use and Care Information:

- Replace this accessory with a new one if it is damaged or discolored excessively.
- When this accessory becomes dirty, rinse it thoroughly with cool water to remove loose dirt, then wipe with a clean cloth or sponge.
- Never use petroleum solvents such as gasoline, thinner, benzene, acid or alkaline cleaners.

For additional assistance, please contact Kolpin customer service department at (877) 956-5746 or (763) 478-5800 or email customerservice@kolpin.com

One Year Limited Warranty

For the period of one (1) year from the purchase date, Kolpin will replace for the original purchaser, free of charge, any part or parts found upon examination by Kolpin to be defective in material, workmanship, or both.

All transportation costs incurred submitting product to Kolpin for warranty consideration must be borne by the purchaser. If Kolpin determines that the product must be returned to the factory for credit, please call 1-877-956-5746 for a Return Merchandise Authorization (RMA) number and shipping instructions.

This warranty does not apply to parts that have been damaged by accident, alteration, abuse, improper maintenance, normal wear, or other causes beyond the manufacturer's control. In order to protect you and your ATV, certain parts of the accessory system and/or hardware are designed to fail when the equipment is over-stressed. Parts that are lost due to loosening and improper maintenance are not covered under warranty. This warranty does not cover removal or reinstallation labor fees of the accessory system and related components.

Peripheral products such as engines, electric motors, and actuators may carry an original manufacturer's warranty. Most hardware is general in nature and is easily obtained locally. Be sure to replace with minimum metric class 8.8 specification.